

Green Pin® Sling Shackle, Bow Shackle with Safety Bolt, Nut and Pin

- **Material:** bow and pin in high-tensile steel, grade 8, quenched and tempered
- **Safety factor:** Minimum breaking load = 5 times WLL (load capacity)
- **Surface:** bow painted silver, pin painted green
- **Temperature range:** -20°C to +200°C
- **Certificates:** On request a works test certificate, certificate of basic raw material, manufacturer's test certificate and/or CE certificate of conformity are available. All shackles starting from 75 tons come with a Lloyd's Register of Shipping proof load certificate.
- **Note:** Inner width and length \pm 5% forging tolerance

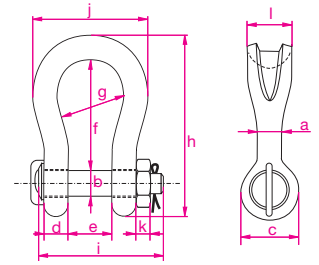

WLL in t	Dimensions in mm												Weight in kg/pce	Item no.
	a	b	c	d	e	f	g	h	i	j	k	l		
18	35	35	69	30	54	148	102	239	171	180	29	64	8	25301810015157
30	40	42	90	35	69	165	126	279	207	200	34	79	13	25301810015158
40	55	51	109	45	84	199	140	331	252	235	38	97	21	25301810015159
55	60	57	115	55	90	240	160	389	294	270	45	100	30	25301810015160
75	68	70	125	54	110	290	185	473	327	317	54	120	48	25301810015161
125	85	80	154	85	137	366	220	583	426	390	64	150	92	25301810015162
150	94	95	179	89	147	391	253	645	435	434	50	170	140	25301810015163
200	110	105	199	100	158	481	280	759	470	482	50	205	205	25301810015164
250	126	120	227	110	179	542	300	859	519	530	60	240	264	25301810015165
300	135	134	245	122	195	601	350	947	575	620	70	265	360	25301810015166
400	160	160	293	145	231	576	370	985	675	690	80	320	580	25301810015167
500	170	180	328	160	263	681	450	1131	748	790	90	339	780	25301810015168
600	190	200	348	170	289	741	490	1234	809	865	100	370	980	25301810015169
700	200	215	392	190	315	751	540	1284	879	901	100	400	1360	25301810015170
800	218	230	420	200	342	851	554	1426	942	947	110	420	1430	25301810015171
900	242	255	466	220	368	851	580	1488	1023	1023	120	440	1650	25301810015172
1000	260	270	490	240	399	851	614	1532	1103	1107	120	460	2970	25301810015173
1250	285	300	510	260	452	931	650	1666	1227	1182	150	530	3700	25301810015174
1550	285	320	550	280	483	950	680	1710	1300	1253	150	560	4000	25301810015175

Green Pin® Polar Shackle, Bow Shackle with Safety Bolt, Nut and Pin

- **Material:** bow and pin in high-tensile steel, grade 8, quenched and tempered
- **Safety factor:** Minimum breaking load = 5 times WLL (load capacity)
- **Standards:** EN 13889 und erfüllt die Leistungsanforderungen der US Fed. Spec. RR-C-271 Type IVA Class 3, Grade B
- **Surface:** hot-dip galvanised
- **Temperature range:** -40°C to +200°C
- **Certificates:** On request a works test certificate, certificate of basic raw material, manufacturer's test certificate and/or CE certificate of conformity and/or DNV 2.7-1 certificate are available.
- **Note:** Inner width and length \pm 5% forging tolerance, for shackles with a WLL of 55 to and 85 to, the MBL is 6 times the WLL

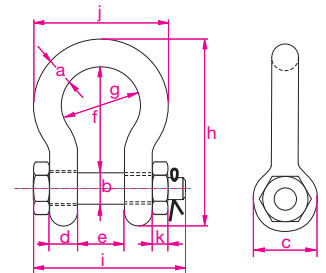
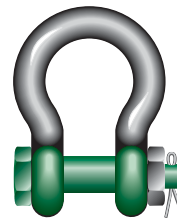

WLL in t	Dimensions in mm												Weight in kg/pce	Item no.
	a	b	c	d	e	f	g	h	i	j	k			
2	13.5	16	34	13	22	51	32	89	82	58	13	0.42	25301810015143	
3.25	16	19	40	16	27	64	43	110	98	75	17	0.74	25301810015144	
4.75	19	22	46	19	31	76	51	129	114	89	19	1.18	25301810015145	
6.5	22	25	52	22	36	83	58	144	130	102	22	1.77	25301810015146	
8.5	25	28	59	25	43	95	68	164	150	118	25	2.58	25301810015147	
9.5	28	32	66	28	47	108	75	185	166	131	27	3.66	25301810015148	
12	32	35	72	32	51	115	83	201	178	147	30	4.91	25301810015149	
13.5	35	38	80	35	57	133	92	227	197	162	33	6.54	25301810015150	
17	38	42	88	38	60	146	99	249	202	175	19	8.19	25301810015151	
25	45	50	103	45	74	178	126	300	249	216	23	14.22	25301810015152	
35	50	57	116	50	83	197	138	334	269	238	26	19.85	25301810015153	
42.5	57	65	130	57	95	222	160	377	301	274	29	28.33	25301810015154	
55	65	70	145	65	105	260	180	433	330	310	32	39.59	25301810015155	
85	75	83	162	73	127	329	190	527	380	340	40	62.00	25301810015156	